

RockLock Plus II

INSTALLATION & MAINTENANCE

PRIOR TO INSTALLATION

It is important to work out of several cartons to mix the patterns when installing this select flooring product to enhance the beauty of nature without having duplicate planks beside each other. RockLock Plus II offers the natural colors and texture variations that are abundantly available in nature to give a beautiful finished installation within the home. RockLock Plus II should never be installed outdoors, or in areas that will not constantly stay between 23° F and 140° F.

Before you begin installation it is extremely important that subfloor preparations are performed as follows:

SUBFLOOR

1. Subfloor must be level, flat, and structurally sound. The subfloor levelness must not exceed 1/8" level within a 6' span in all directions. It is suggested to use either a level or a straightedge. Grind high spots down and level low spots with a water resistant non-shrinking Portland leveling compound. Be certain the floor joists do not impede the floor flatness as required. Unevenness can cause problems with the integrity of the locking system and cause the system to disengage.
2. Concrete substrates must be fully cured before installation for a minimum of 30 days or more. Concrete subfloors must be dry, smooth, and free from dust, solvent, wax, asphalt sealing compounds, and other materials that may compromise the backing of the flooring.
3. Underlayment with cushioning properties may not be used under RockLock Plus II under any circumstances, as the product has an attached IXPE pad.
4. It is the installer's responsibility to be certain the subfloor guidelines are followed before installation begins.

RockLock Plus II may be installed above, on, or below grade over acceptable subfloor types:

1. Concrete slab
2. APA Rated plywood underlayment
3. Properly prepared gypsum cement.
4. Underlayment grade particleboard
5. OSB minimum 3/4"
6. Existing Hardwood floor
7. Ceramic Tile
8. Single layer resilient tile and sheet vinyl
9. Floating or fiber back cushion vinyl products are not recommended
10. Existing hard surface floor covering must be securely fastened

RockLock Plus II

INSTALLATION & MAINTENANCE

GENERAL GUIDELINES

ACCLIMATION: HVAC system for the installation must be operational and turned on to provide a temperature of 50-85°F. The product does not have to be acclimated, but it must be the same temperature as the room before installation.

DIRECT SUNLIGHT: The installed flooring should be protected from excessive exposure to direct sunlight.

CRAWL SPACE: The bottom of wooden subfloor joists must be a minimum of 18" above ground surface. Minimum 6 mil black poly sheeting must be in place covering 100% of the ground and overlapped a minimum of 6" at seams acting as a moisture barrier. The polysheeting must run up the walls no less than 6". Air vents must be open on all sides with no less than 1.5% air vent opening compared to the total crawlspace area.

RADIANT HEAT: Only embedded radiant heat is recommended. Temperature should be reduced three days before installation to no more than 65°F. After installation, slowly increase the temperature a maximum of 5°F per 24 hour period. Temperatures should never exceed 85°F.

Warning: Heating mats are not recommended for our WPC flooring.

EXPANSION GAPS: A minimum of 1/4" expansion gap must be allowed for all vertical obstructions including door jambs. If lengths or widths of installed areas of the product exceed 40 feet in any direction, a minimum of 3/8" expansion gap must be allowed for all vertical obstructions, including door jambs. Do not exceed 65 feet in any direction, even with the 3/8" expansion space without the approval of Eastern Flooring Products® technical sales department.

GENERAL GUIDELINES

1. Tape measure
2. Tapping block (trimmed piece of flooring)
3. Pencil
4. Pry bar or pull bar
5. Chalk line
6. Crosscut power saw
7. 3M Scotch-Blue Tape 2080
8. Rubber mallet
9. White wood glue

IMPORTANT REQUIREMENTS BEFORE INSTALLING

1. Be certain a minimum of 1/4" expansion gap is allowed for all vertical obstructions including

RockLock Plus II

INSTALLATION & MAINTENANCE

door jambs. If lengths or widths of installed areas of the product exceed 40 feet in any direction, a minimum of 3/8" expansion gap must be allowed for all vertical obstructions, including door jambs. Please check local building codes before undercutting metal door jambs. Do not exceed 65 feet in any direction, even with the 3/8" expansion space without the approval of Eastern Flooring Products® technical sales department.

2. Be certain the subfloor is sound, flat, dry, and level. Floor levelness should not exceed 1/8" in a 6' radius span. Using a 6' or longer level or straightedge, slide along the subfloor looking for low and high areas, which must be either ground down or filled with an approved Portland based leveling compound. Eastern Flooring Products® is not responsible for flooring failures resulting from unsatisfactory subfloors.

3. Wood subfloors must be secure making sure it is either nailed or screwed every 6" along the joists to avoid squeaking.

4. Eastern Flooring Products® recommends, crawl spaces have a black 6 to 20 mil thick moisture barrier properly installed. Moisture will not affect RockLock Plus II but it may permeate into the walls and structure of the building exposing you to problems with mold (and/or) mildew (and/or) excessive subfloor expansion/contraction.

5. Do Not install RockLock Plus II where it will be in direct sunlight for extended periods of time.

6. Eastern Flooring Products® cannot be responsible for installing planks with visible defects.

7. Existing floors such as ceramic, resilient tile and non-cushioned sheet vinyl must be well bonded to the subfloor. Do not sand existing vinyl floors, as they may contain asbestos.

INSTALLATION ILLUSTRATIONS (7.08" WIDE PRODUCT)

1

PREPARE FLOOR

Install on dry and level subfloor.

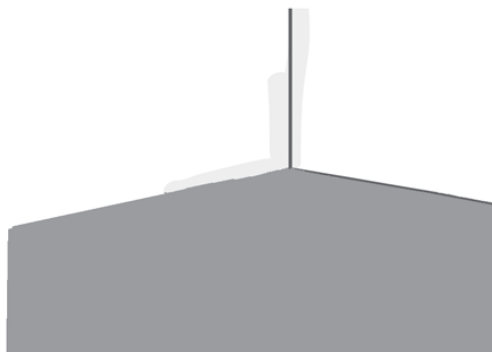

2

SET SPACERS

Place spacers equaling the thickness for required expansion gap between plank and wall on short and long ends of plank.

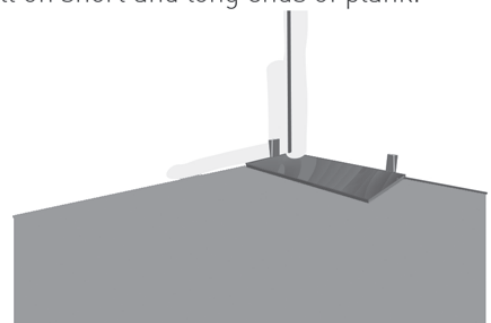

RockLock Plus II

INSTALLATION & MAINTENANCE

3a SHORT SIDE - 3L TripleLock - One piece drop-lock system

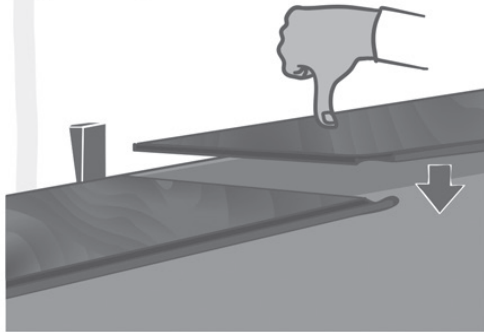

3b Secure 3x locking

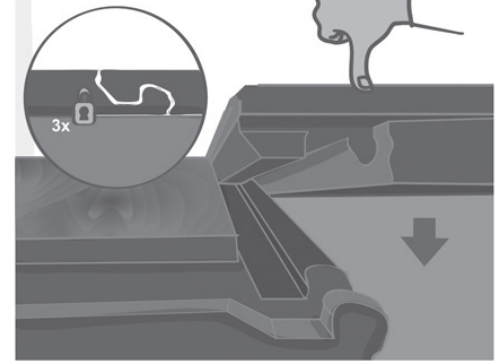

4 LONG SIDE - Click4U - Angle-system

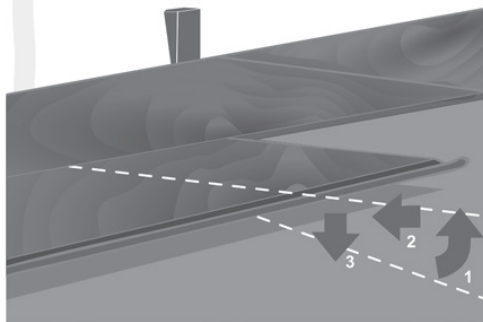

5 Easy angle/drop-lock installation

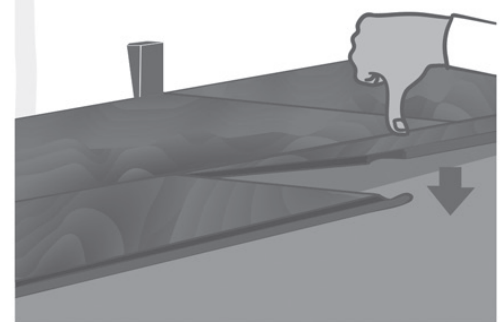

USING THE ANGLE/DROP-LOCK INSTALLATION

1. Work from multiple cartons and “dry lay” several rows before beginning to install insuring duplicate planks are not installed beside each other.
2. Measure the room to ensure that the last row will not be smaller than $\frac{1}{2}$ the width of the product. If so, rip the first row to accommodate the last row.
3. Begin the first row working right to left. Insert minimum $\frac{1}{4}$ ” spacers around the perimeter of the room allowing for proper expansion space, use $\frac{3}{8}$ ” spacers if any run of material exceeds 40 linear feet, but does not exceed 65 linear feet. For installations exceeding 65 linear feet, please contact technical services. (Figure 2). The tongue should be facing the wall. Lay the next plank and connect the short joint (Figure 3 A/B) by placing it directly in the short side locking mechanism, ensure a complete connection between the two. Press the plank

RockLock Plus II

INSTALLATION & MAINTENANCE

down until you hear an audible clicking sound.

4. Insert the second row by sliding the long joint tongue into the groove of the plank in the first row. (Figure 4) Pull the plank towards the previously installed row until it is fully engaged. Install the second piece the same way, butting it to the first piece and engaging it the same way as the short side drop-lock in row one. Be certain to allow a minimum of 8" between end joints on the adjacent plank. The shortest starting or ending plank should not be less than 8" in length.
5. If necessary you can use a non-marring rubber mallet to gently tap the drop-lock mechanism together.
6. Install the remaining rows in the same manner (figure 5).
7. Use cut pieces from a previous row as the starter board to reduce waste being certain it is at least 8" in length.

MOLDING INSTALLATION

1. Eastern Flooring Products® recommends using Eastern Vinyl Stair Caps on stairs. Matching stair caps and risers can be purchase from your source for RockLock Plus II.
2. All molding should be dry fit prior to flooring installation to ensure proper fit, finish, and match.

AFTER INSTALLATION

1. Furniture should be moved onto the newly installed floor using an appliance hand truck over hardboard runways.
2. Avoid excessive exposure to direct sunlight.
3. Indoor temperatures should always stay between 23° and 104° F.
4. Oil or petroleum-based products can result in surface staining. Do not track asphalt-driveway sealer or other oil based products on to the flooring. Use protected walk-off mats that are non-staining. Rubber may discolor the floor.
5. Furniture should be equipped with felt pads to avoid scratching the floor. Heavy furniture and appliances should be equipped with non-staining large surface floor protectors. Furniture with wheeled castors should only have wide castors no less than 4" in diameter. Office areas must have a protective mat under chairs. DO NOT use ball-type castors.
6. Floating floors must not be pinned with fixed cabinetry, heavy equipment or other heavy objects. This includes kitchen counters, slate pool tables, or other objects that would pin the floor from floating. If you have questions about a given piece of furniture, machinery, or otherwise heavy object, please contact Eastern Flooring Products® technical services.



RockLock Plus II

INSTALLATION & MAINTENANCE

7. Moldings from another flooring segment must not be nailed through the planks.
8. Use walk-off mats at entrances to prevent dirt and grit from being tracked on to the floor.
9. Sweep or vacuum the floor regularly to remove loose dirt. DO NOT use vacuums that use a beater bar or turn beater bar off.
10. Damp mop as needed using clean water and a diluted neutral-PH floor cleaner. DO NOT use detergents, abrasive cleaners or “mop and shine” products. Use caution as with all smooth surface floors may become slippery when wet. Allow time for floor to dry after cleaning.

WARNING: Existing resilient floor coverings and black asphalt adhesive may contain asbestos. Improper removal procedures could release asbestos fibers into the air. Asbestos fibers, when inhaled, could cause serious bodily harm. Do not sand or dry scrape these materials. If removal of existing floor coverings is necessary, be certain that all precautions are taken and proper procedures are followed. For information regarding proper removal procedures in the U.S.A., please consult the Resilient Floor Covering Institute (966 Hungerford Drive, Suite 12-B, Rockville, MD 20850) for a pamphlet, “Recommended Work Practices for the Removal of Resilient Floor Coverings.”